



OPS-WHT-15751UFS+ OPS-WHT-15201

SPECIFICATION DATA SHEET

PRODUCT DETAILS

<b>Manufacturer :</b>	Jaquar	<b>Type:</b>	Bowl for coupled closet WC (S trap )
<b>Range</b>	Opal	<b>Outlet</b>	Vertical
<b>Colour:</b>	White	<b>Material:</b>	Ceramic - Vitreous China
<b>Technical Details:</b>	External diameter of outlet $\phi$ 100 +5 -2 mm	<b>BOM doc.NO.</b>	JSW/01/2018/0108 JSW/01/2018/0159

ARTICLE NAME: COUPLE CLOSET BOWL-WC



TECHNICAL DIMENSIONS

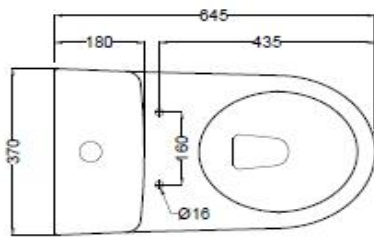

TOP VIEW

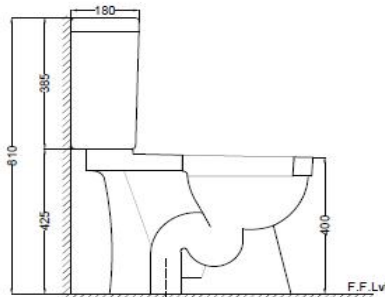

SIDE VIEW

ALL DIMENSIONS ARE IN MM.  
(TOLERANCE  $\pm$  5 MM)

PRODUCT DIMENSIONS				USP
Length (mm)	Width (mm)	Height (mm)	Net weight (kg)	Box rim with UF seat cover, dual flushing, Anti germ glaze
370	645	810	31.80	
ACCESSORIES PROVIDED				
UF Soft Close Seat cover			OPS-WHT-15105UF	
Floor fixing screw			ZPS-SNS-FB01	
Wax Seal				

CARE AND CLEANING GUIDELINES

- ★ Vitreous china sanitary ware products are fragile in nature and need to be handled with care (to avoid personal injury) at all times during its storage, handling, installation and use thereafter.
- ★ The product is heavy and it is recommended that two persons hold it while it is being fixed.
- ★ Carefully inspect the new product for damage before installation.
- ★ Risk of product damage. Over tightening may cause breakage or chipping of vitreous china.
- ★ Risk of external leakage. Do not lift or rock the bowl after placement.
- ★ Always test your cleaning solution on an inconspicuous area on the product before applying it to the entire surface.
- ★ Do not allow cleaners to sit or soak on the product.
- ★ Use a soft, dampened sponge or cloth to clean. Never use abrasive material like a bristle brush or scouring pad.
- ★ Wipe surfaces clean and rinse completely with water immediately after applying cleaners.
- ★ Clean Chrome, stainless steel surfaces once a week. Do not use cleaners containing chloride on chrome, stainless steel. If used, rinse the surface immediately to prevent corrosion.
- ★ Wherever chrome plating is used on the products, use only warm water to clean and then dry with a soft cloth.

CERTIFICATION

Compliance : IS 2556.2:2004, IS 2556.1:1994 , EN 997 :2012+A1, BS EN 14124:2004

All technical dimensions are in accordance to British standards, Bureau of Indian Standards

PACKAGING DETAIL				LOADING PALLET DETAIL			
Length (mm)	Width (mm)	Height (mm)	Gross Weight(kg)	Length (mm)	Width (mm)	Height (mm)	no of pieces on pallet
640	355	420	22.3	1140	1140	2285	16
390	460	215	11.9	1140	1140	2285	60



Prepared By Designer Date	Controlled By Quality control	Verified By Product Manager	Approved By Sanitaryware Head
Revision/Version	1	Plotter Updated on	Month 10-Jul Year 2018