

TOP VIEW

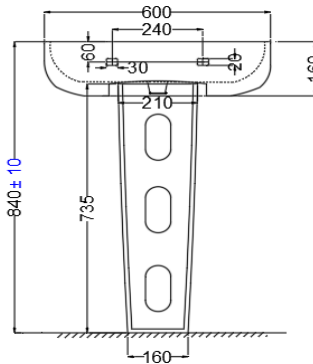

SIDE VIEW

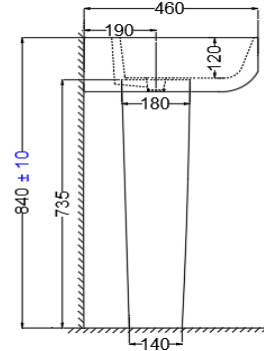

BACK VIEW

GENERAL INFORMATION

Product Code	VGS-WHT-81801PM+VGS-WHT-81301PM
Brand	Jaquar
Colour	White
Type	Wall Hung Basin with full pedestal
Material	Ceramic-Vitreous China (VC)

PRODUCT SPECIFICATION

Product Dimension	600x460x160 mm with Pedestal 840 mm
Basin Inner Dimension	550X335X120 mm Pedestal 200X180X735 mm
Product Net Weight	13.5 kg. Pedestal 9.0 kg
Product Gross Weight	15 kg. Pedestal 10.0 kg
Packaging Dimension	610x170x470 mm Pedestal 745x205x190 mm
Outlet	Vertical
Tap Hole And Outlet Hole Dimension	Tap hole dia. $\varnothing 35 \pm 2$ mm
	Internal diameter of outlet hole dia. $\varnothing 45 +2/-1$ mm
	Horizontal distance between the center line of the tap hole and the center line of the waste outlet hole ≤ 135 mm

PRODUCT FEATURES

Product Features	Wall hung Basin, Integrated Design With Tap Hole and overflow hole, anti germ glaze
------------------	---

ACCESSORIES INCLUDED

Rag bolt	ZPS-MST-RB03
Over Flow Hole Cap	ZPS-WHT-9012B

ACCESSORIES RECOMMENDATION

Full Pedestal	VGS-WHT-81301PM
---------------	-----------------

CARE AND CLEANING GUIDELINES

- Vitreous china sanitary ware products are fragile in nature and need to be handled with care (to avoid personal injury) at all times during its storage, handling, installation and use thereafter.
- The product is heavy and it is recommended that two persons hold it while it is being fixed.
- Carefully inspect the new product for damage before installation. Recommended to inspect the sanitaryware with wooden Hammer.
- Risk of product damage. Over tightening may cause breakage or chipping of vitreous china. Recommended to use hard rubber & nylon spacer in between ceramic & metal fixtures.
- Risk of external leakage. Do not lift or rock the bowl after placement.
- Always test your cleaning solution on an inconspicuous area on the product before applying it to the entire surface.
- Do not allow cleaners to sit or soak on the product.
- Use a soft, dampened sponge or cloth to clean. Never use abrasive material like a bristle brush or scouring pad.
- Wipe surfaces clean and rinse completely with water immediately after applying cleaners.
- Clean Chrome, stainless steel surfaces once a week. Do not use cleaners containing chloride on chrome, stainless steel. If used, rinse the surface immediately to prevent corrosion.
- Wherever chrome plating is used on the products, use only warm water to clean and then dry with a soft cloth.
- Recommended to use Genuine Accessories.

QUALITY MANAGEMENT SYSTEM - ISO 9001

DISCLAIMER: Our every effort has been made to ensure factual accuracy, the information presented subject to changes due to requirements in different sites, markets and/ or countries. All dimensions are in mm (Tolerance ± 5 MM). Jaquar reserves the right to make the necessary amendments at any time without prior notice.

For Installation Refer Actual Product. Last modified on 11 September 2025.