

GEM BLAZE 3W

GEM BLAZE ROUND DOWNLIGHT

Indoor Luminaire

Product Code:

LGEMB01R03XC / LGEMB01R03XN / LGEMB01R03XW

3W - 255lm - 6500K - CRI>80 - Beam Angle - 65°

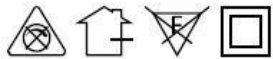

Technical Specifications

Operating Temperature	-10°C to 40°C
Rated Input Voltage & Frequency	220 ~ 240 VAC, 50Hz
Rated Input Wattage	3W ± 10%
Rated Input Current	0.018 Amp (Nominal)
Power Factor	≥0.90
THD	<20%
Rated Luminous Flux	255 lm / 240 lm / 225 lm (tolerance as per BIS)
Rated Luminaire Efficacy	85 lm/W / 80 lm/W / 75 lm/W (tolerance as per BIS)
Correlated Color Temperature (CCT)	6500 K / 4000 K / 3000 K (tolerance as per ANSI)
Color Rendering Index (CRI)	>80
Beam Angle	65°
Driver Efficiency	≥80%
LED Life Span	>50000 Hrs (Ta=25°C @L70)
Housing	PC Housing
Lens / Reflector	PC Diffuser
Mounting	Recessed

Protections

Over Voltage Protection	Withstand upto 440V/AC for 4 Hrs.
Surge Protection	±4.0KV
Protection Class	Class II
Ingress Protection (IP Rating)	IP20
Impact Protection (IK Rating)	IK02
Short Circuit Protection	Provided
Open Circuit Protection (No Load)	Provided
Reverse Polarity Protection	Provided

Light Distribution

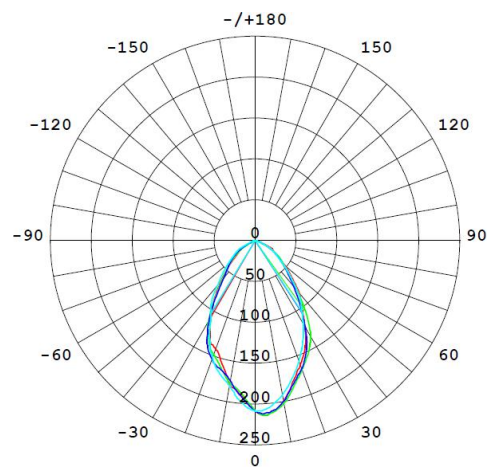

UGR Table

ceiling/cavity		0.7	0.7	0.5	0.5	0.3	0.7	0.7	0.5	0.5	0.3
walls		0.5	0.3	0.5	0.3	0.3	0.5	0.3	0.5	0.3	0.3
working plane		0.2	0.2	0.2	0.2	0.2	0.2	0.2	0.2	0.2	0.2
Room dimensions		Viewed crosswise					Viewed endwise				
x = 2H y = 2H	2H	14.8	16.1	15.1	16.2	16.4	14.4	15.7	14.7	15.8	16.0
	3H	15.3	16.5	15.6	16.7	16.9	14.9	16.0	15.2	16.2	16.4
	4H	15.3	16.4	15.6	16.6	16.8	14.9	15.9	15.1	16.1	16.4
	6H	15.3	16.2	15.6	16.5	16.8	14.8	15.8	15.1	16.0	16.3
	8H	15.2	16.2	15.5	16.4	16.7	14.8	15.7	15.1	16.0	16.3
	12H	15.2	16.1	15.5	16.4	16.7	14.7	15.6	15.0	15.9	16.2
4H	2H	15.1	16.2	15.4	16.4	16.6	14.8	15.8	15.1	16.1	16.3
	3H	15.6	16.5	15.9	16.8	17.1	15.2	16.1	15.6	16.4	16.7
	4H	15.6	16.4	15.9	16.7	17.0	15.2	16.0	15.6	16.3	16.7
	6H	15.6	16.3	15.9	16.6	17.0	15.2	15.9	15.6	16.3	16.6
	8H	15.5	16.2	15.9	16.6	16.9	15.2	15.8	15.6	16.2	16.6
	12H	15.5	16.1	15.9	16.5	16.9	15.1	15.7	15.5	16.1	16.5
8H	4H	15.5	16.2	15.9	16.5	16.9	15.1	15.8	15.5	16.2	16.5
	6H	15.5	16.0	15.9	16.4	16.9	15.1	15.7	15.6	16.1	16.5
	8H	15.5	16.0	15.9	16.4	16.8	15.1	15.6	15.6	16.0	16.5
	12H	15.4	15.8	15.9	16.3	16.8	15.1	15.5	15.5	15.9	16.4
12H	4H	15.5	16.1	15.9	16.4	16.8	15.1	15.7	15.5	16.1	16.5
	6H	15.5	15.9	15.9	16.4	16.8	15.1	15.6	15.5	16.0	16.4
	8H	15.4	15.9	15.9	16.3	16.8	15.1	15.5	15.5	15.9	16.4
Variations with the observer position at spacings(CIE Pub.117):											
S = 1.0H		+ 0.7 / - 0.9					+ 0.8 / - 1.0				
1.5H		+ 0.8 / - 0.8					+ 0.6 / - 0.5				
2.0H		+ 1.3 / - 1.6					+ 1.2 / - 1.0				

With our continuous efforts to upgrade the technology/product, all product specifications and data are subject to change without prior notice. We always try to maintain the accuracy of our product images, but due to different viewing conditions, the colors may vary. Images are only for indicative purpose.

Product Dimensions (DiaxH)

Ø 74.5 X 42mm (Tol. ± 5 mm), Cutout Size 55.5mm

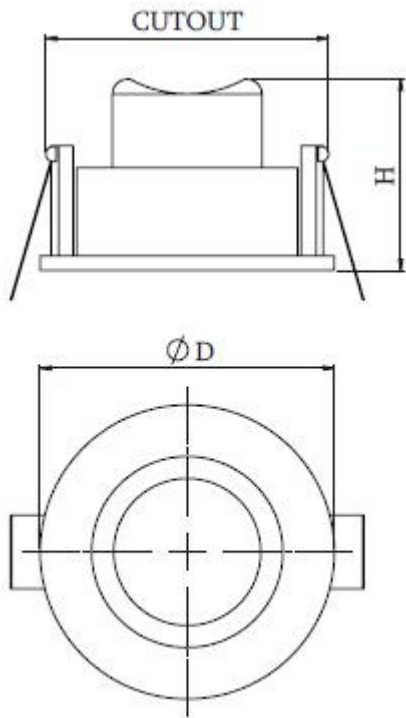

Applications

Residences, Offices, Small Retail Shops,
Hotels, Coffee Shops, Restaurants, Hospitals,
area lighting and for other indoor applications.